

37"

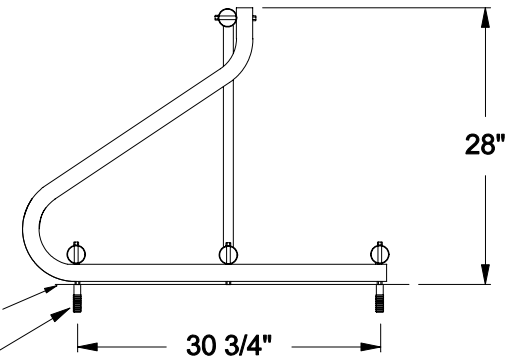

28"

30 3/4"

EXISTING CONCRETE PAD  
LAG BOLT ANCHOR SHEILD  
AND 3/8"x 6" LAG BOLT

(THE ANCHORS ARE ORDERED SEPARATE  
FROM THE BIKE RACK IF ANCHORING IS DESIRED)

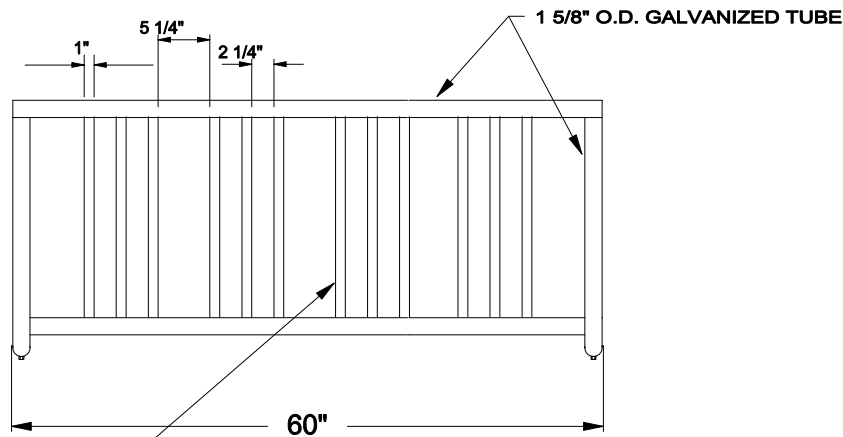

1 5/8" O.D. GALVANIZED TUBE

1" 5 1/4" 2 1/4"

60"

1" O.D. GALVANIZED TUBE

8 SPACES (4 EACH SIDE)  
ALL WELDS ARE COLD GALVANIZED AND PAINTED SILVER

<b>KAY PARK</b>			
MODEL	<b>8052</b>		WT. <b>98 lbs.</b>
DRAWN BY	<b>CKB</b>	DATE	<b>7/06</b>
		SCALE	<b>NONE</b>

FILE NO. 8052